

V250 SERIES SLIDING DOOR

FEATURES

- ◇ **Commercial Framing System**
 - 5 5/8" main frame (4 9/16" fin to interior)
- ◇ **Enhanced Design**
 - Mitered and fusion welded corners
 - 0.075" vinyl thickness
 - Aluminum sill
 - Integral nailing fin
 - Additional galvanized steel reinforcements to meet
- ◇ **Glazing**
 - 1" insulated glass
 - Low-E with argon gas
- ◇ **Hardware**
 - Heavy-duty tandem wheel rollers make operation easy and smooth
 - D-Loop Plated Hardware with either thumb latch or keyed locking system
- ◇ **Screen**
 - Extruded aluminum screen frame with BetterVue™ mesh with WaterShed® technology
- ◇ **Colors**
 - White or Sandstone vinyl (interior/exterior)

BENEFITS

- ◇ The capacity to match exterior colors for unique project facades
- ◇ The ability to facilitate custom sizes for taller and wider door openings

PERFORMANCE

- ◇ Structural & Thermal (test reports or thermal simulations available upon request)

Model	Sliding Door
	Active-Fixed
AAMA/WDMA/CSA 101/I.S.2/A440-08 Rating	R-50
Structural Load P.S.F.	75.19
Air at 25 MPH (cfm/ft ²)	<0.30
Water (No Penetration) P.S.F.	7.52
U-Value (ranges based on multiple Low-E/Argon combinations)	0.24 - 0.30
SHGC (ranges based on multiple Low-E/Argon combinations)	0.14 - 0.51
Test size	72" x 82"

OPTIONS

- ◇ **Available Configurations**
 - Fixed-Active
 - Active-Fixed
 - Glide-Fixed-Fixed, Fixed-Glide-Fixed or Fixed-Fixed-Glide
 - Fixed-Active-Active-Fixed
 - Sidelites
 - Transoms
 - Special sizing for ADA purposes
 - Reversible panels only on doors less than 72" tall (some in-field assembly will be required)
- ◇ **Muntin Choices**
 - Internal or simulated divided lites available
- ◇ **Screen**
 - Extruded aluminum screen frame with aluminum wire mesh
 - Extruded aluminum screen frame with sunscreen mesh
 - Extruded aluminum screen frame with stainless steel 0.009" thickness mesh
- ◇ **Glazing**
 - Triple glazing (Energy TG)
 - Capillary tubes
 - Wide variety of glazing, tinting and thickness options
- ◇ **Panning & Trim Choices**
 - Wide variety of panning, receptor and trim available
- ◇ **Mulling**
 - Wide variety of structural mulls
- ◇ **Colors**
 - Twelve painted exterior colors (with White or Sandstone vinyl interior)
 - Textured black paint (exterior/interior)
 - Textured Black paint (exterior only/white interior)
 - Unlimited custom painted exterior colors

V250 SERIES SLIDING DOOR

This document contains confidential and proprietary information intended for the private use of Quaker.
© 2016 Quaker Window Products Co., INC. All rights reserved.
Quaker reserves the right to change any/all designs without notice. Due to periodic re-certification requirements, result shown may vary.

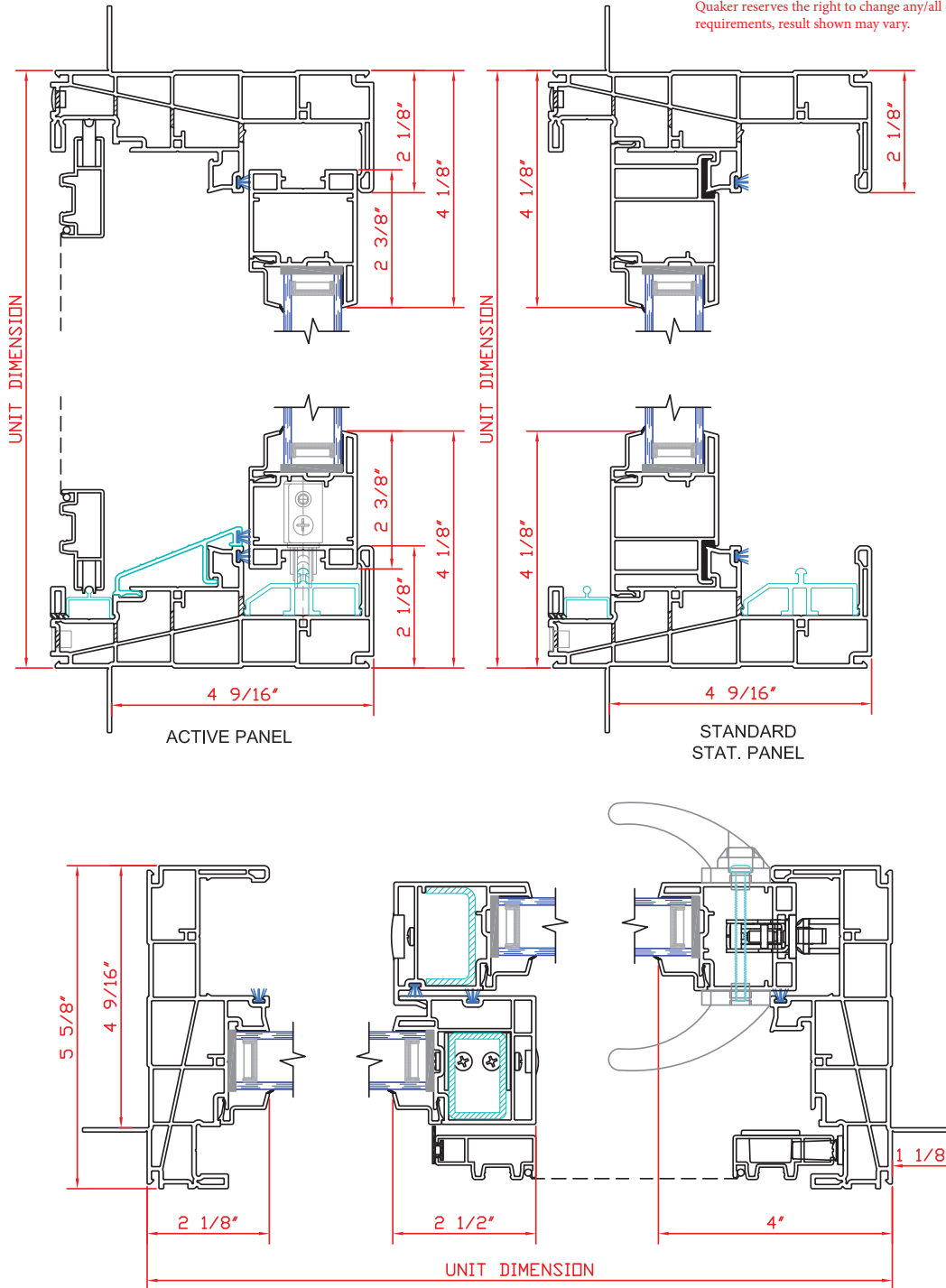

Our products are tested to the standards of and certified by some of the foremost organizations in the fenestration industry.

