



K-12 SCHOOLS

Commercial Windows and Doors | Aluminum | Vinyl | Wood Clad



Products and Project References

www.QuakerCommercialWindows.com

Educational Sector projects are rarely elemental.

There are many school types in the K-12 world; public and private, kindergarten all the way up to high school. Some with 50 students. Others with a thousand or more. At Quaker, we've worked with every type, so we know that with this varied collection, there's rarely an instance when one school's build is the same as another.

While every school has its own distinctive attributes, most projects in the K-12 market segment-- whether new construction or replacement -- propose many of the same characteristics:

- shorter time frames to complete the job
- acute attentiveness to delivery schedules
- maximum safety features with full-functionality
- the ability to withstand everyday wear and tear
- high energy-efficiency where needed
- a keen eye kept on allotted budgets

At Quaker Windows, we fully understand all of these aspects and that's why we're so effective when working within the educational market.

Along with our immeasurable experience, our vast product line can work for any type of project within the K-12 field -- from meeting the design expectations of new, modern educational centers to fulfilling historical specifications for treasured community institutions.



Photo by Ed Wonek Art Works, Inc.



Bristol County Agriculture High School
Dighton, MA
General Contractor: Gilbane Building Co.
Architect: HMFH Architecture
Glazing Contractor: Kapiloffs Glass Inc.



www.QuakerCommercialWindows.com

Aluminum Windows and Doors

Hung | Casement | Project-Out | Slider | Fixed | Doors

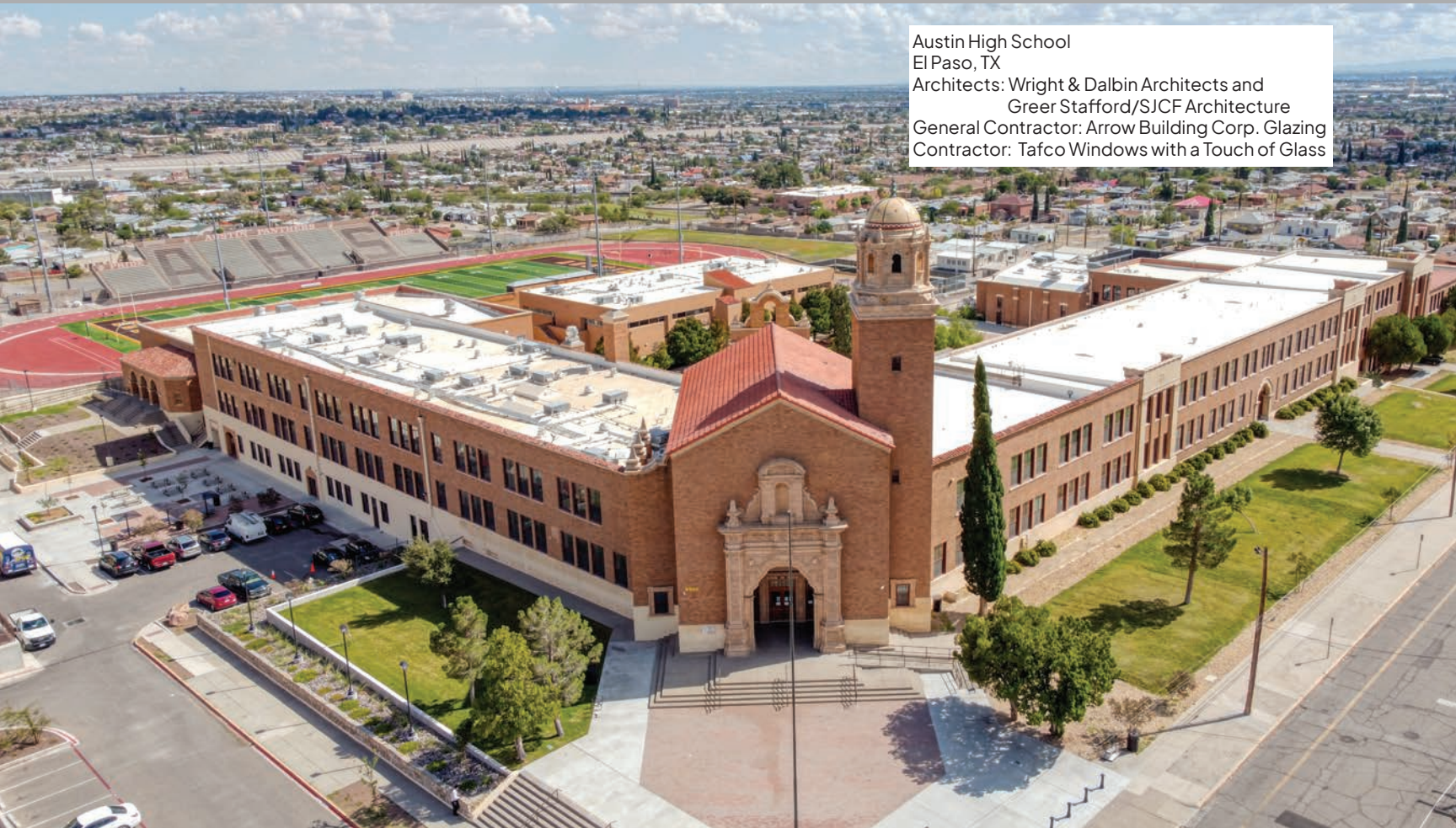

Austin High School
El Paso, TX
Architects: Wright & Dalbin Architects and
Greer Stafford/SJCF Architecture
General Contractor: Arrow Building Corp. Glazing
Contractor: Tafco Windows with a Touch of Glass

FEATURES:

- CW to AW ratings
- Architecturally extruded aluminum
- All products include a thermally-broken design
- Patented OptiCore™ technology for enhanced thermal efficiency (C600/C605 only)
- Modern, squared sash frame or Traditional/Historic sash frame (*availability varies based on series and model*)
- ¾" to 1⅜" I.G. with warm-edge spacer
- Commercial-grade hardware
- Full line of operating and fixed window models
- Both Sliding and Terrace Door models
- Product line encompasses New Construction and Replacement applications

BENEFITS:

- Industry-leading thermal efficiencies
- Green initiatives built into every product
- In-house powder coat facility means no lengthy lead times
- Custom color capabilities
- Split color option i.e. separate colors on exterior and interior (C600/C605 only)
- Standard 1" glass package achieves a minimum of 28 STC
- Blinds/Panel option (C600/C605 and E600 only)
- Standard and custom sizing for all models
- Impact and Florida Building approved products

Aluminum Selection Guide

Model	Series	Frame Depth	Structural Test Rating	Test Size	Air Infiltration	Water Resistance	U-Value Range [#]	SHGC Range [#]	STC Range ^X	OITC Range ^X
Casement	C600/C605	4 1/8"	Up to AW100	48" x 84"	<.10	15	.20-.32	.11-.44	28-41	28-34
	E600	3 1/4"	Up to AW100	36" x 72"	<.10	12	.29-.39	.10-.41	31-44	25-34
	H450	3 1/4"	CW90	36" x 60"	<.30	12	.39-.44	.14-.48	34-37	29-32
	M600	3 1/4"	AW-PG70	36" x 72"	<.10	15	.33-.44	.11-.45	29-43	23-31
Project-Out	C600/C605	4 1/8"	Up to AW100	48" x 72"	<.10	15	.20-.32	.11-.44	28-41	28-35
	E600	3 1/4"	AW100	60" x 36"	<.10	15	.26-.37	.10-.41		
	H450	3 1/4"	CW70	60" x 36"	<.30	12	.39-.44	.14-.48		
	M600	3 1/4"	AW-PG70	48" x 72"	<.10	15	.33-.45	.11-.45		
Project-In	E600	3 1/4"	AW100	60" x 36"	<.10	15	.26-.37	.10-.41		
Single Hung	E300	3 1/4"	CW-PG50	56" x 91"	<.30	7.5	.35-.41	.13-.46		
	E500	3 1/4"	AW-PG40	60" x 99"	<.30	8.15	.36-.42	.13-.46		
	H650	4 1/8"	AW-PG60	60" x 99"	<.30	12	as low as 0.30		31-32	24-26
	T500	3 1/4"	AW-PG50	60" x 99"	<.30	10	.37-.43	.14-.50		
Double Hung	E300	3 1/4"	CW-PG50	47" x 59"	<.30	7.5	.35-.41	.13-.46	34-36	28-31
	E500	3 1/4"	AW-PG40	60" x 99"	<.30	8.15	.36-.42	.13-.46		
Horizontal Slider	E300	3 1/4"	CW-PG50	72" x 60"	<.30	7.5	.35-.41	.14-.48		
	E500	3 1/4"	AW-PG50	99" x 79"	<.30	10	.36-.41	.13-.48	33	28
	K200	2 3/8"	CW-PG40	60" x 59"	<.30	6	.37-.48	.14-.51	29-51	24-39
Fixed	C600/C605	4 1/8"	AW-PG100	60" x 99"	<.10	15	.15-.30	.13-.57	28-44	25-35
	E300	3 1/4"	AW-PG50/CW70	60" x 99"	<.10	10	.25-.32	.16-.57		
	E500	3 1/4"	AW-PG50/CW70	60" x 99"	<.10	10	.25-.32	.16-.57		
	E600	3 1/4"	AW-PG100	60" x 60"	<.10	15	.17-.31	.13-.55		
	H450	3 1/4"	AW-PG110	72" x 120"	<.10	15	.25-.32	.16-.57		
	H650	4 1/8"	AW-PG90	60" x 99"	<.10	12				
	K200	2 3/8"	CW50	64" x 71"	<.30	7.5	.27-.33	.16-.37		
	M600	3 1/4"	AW-PG70	60" x 60"	<.10	12	.18-.32	.13-.56	32-41	26-31

*-Ranges based on multiple Low-E/Argon I.G. combinations

X-Ranges based on multiple I.G. combinations

All ratings listed are NAFS certified. Periodic re-certification testing is required thus data shown may vary slightly.



Arlington High School
Arlington, MA
General Contractor: Consigil Construction Co.
Architect: HMFH Architects
Glazing Contractor: R & R Window Contractors

Aluminum Product Selection Guide

Casement

C600 Series

Shown with nailing fin, roto hardware, and modern, square exterior glazing

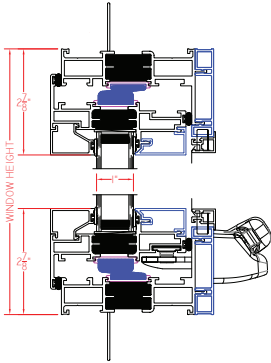

C605 Series

Shown with nailing fin, roto hardware, and traditional, sloped exterior glazing

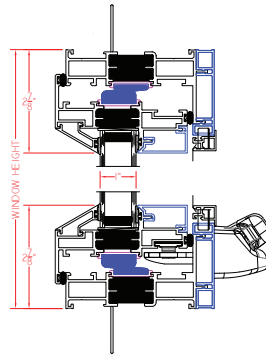

C605 Series with blinds/panel

Shown without nailing fin, with optional triple-pane I.G., roto hardware, beveled exterior glazing

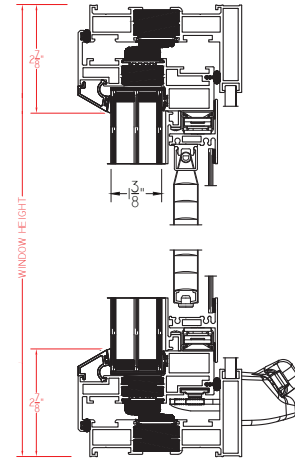

E600 Series

Shown with roto hardware

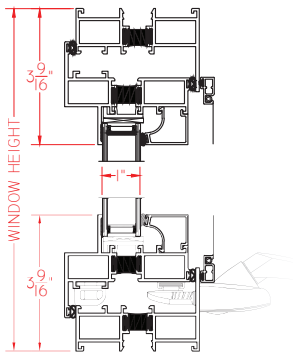

E600 Series with blinds/panel

Outswing model
shown without nail fin, with roto hardware and optional blind/panel

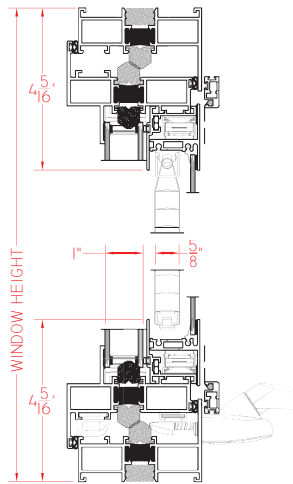

Inswing Model
shown without nail fin, with roto hardware and optional blind/panel

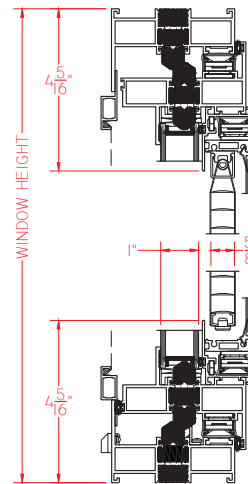

H450 Series

Shown with roto hardware

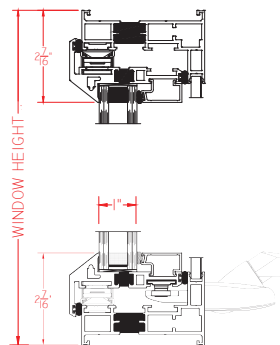

M600 Series

Shown with roto hardware and optional nailing fin

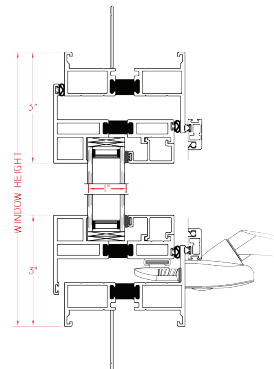

Aluminum Product Selection Guide

Project-Out

C600 Series

Shown with nailing fin, roto hardware, and modern, square exterior glazing

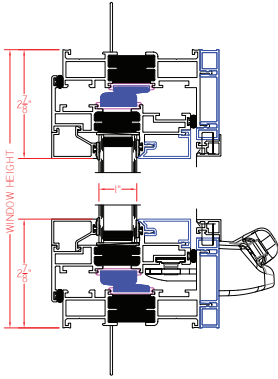

C605 Series

Shown with nailing fin, roto hardware, and beveled exterior glazing

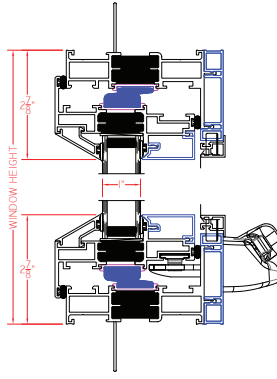

C605 Series with blinds/panel

Shown without nailing fin, triple-pane I.G., roto hardware, beveled exterior glazing and optional blind/panel

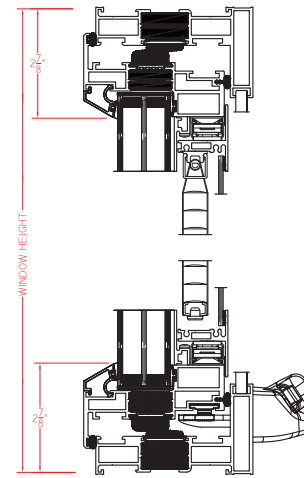

E600 Series

Shown with roto hardware

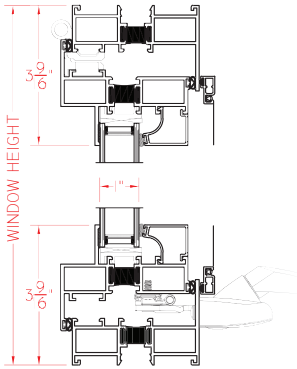

E600 Series with blinds/panel

Shown with roto hardware and optional blind/panel

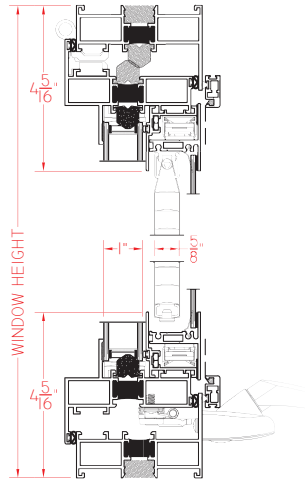

H450 Series

Shown with roto hardware

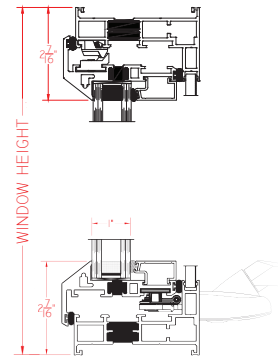

M600 Series

Shown with 4-bar roto hardware

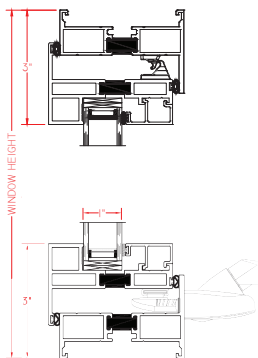

Friendship Aspire Academy-Garland
Little Rock, AR
General Contractor: Kinco Construction
Architect: WER Architects
Glazing Contractor: Glass Erectors



Aluminum Product Selection Guide

Project-In

E600 Series

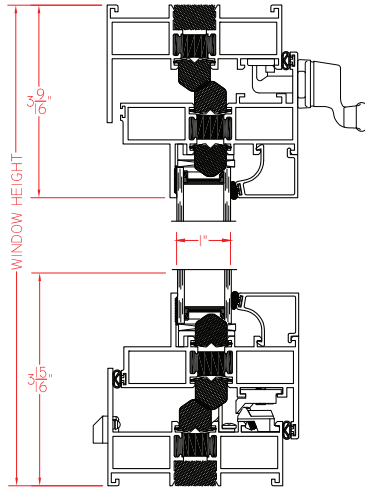

E600 Series with blinds/panel

Shown with optional blind/panel

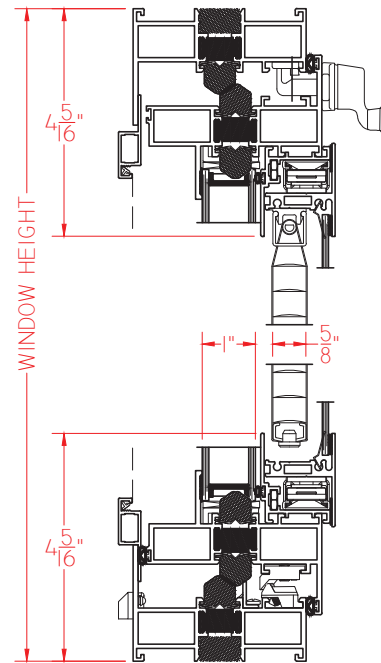

Horizontal Slider

E300 Series

Single Slider model shown

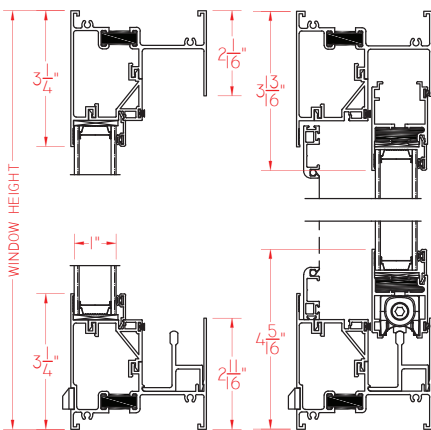

E500 Series

Single Slider model shown

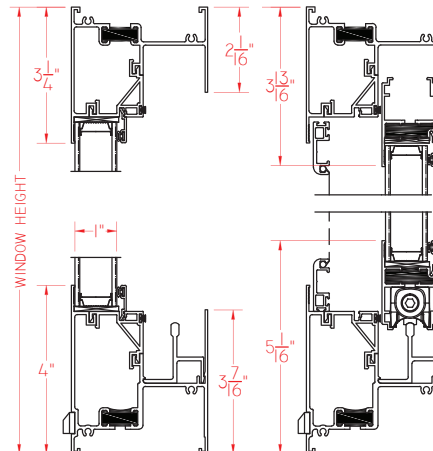

K200 Series

Single Slider model shown

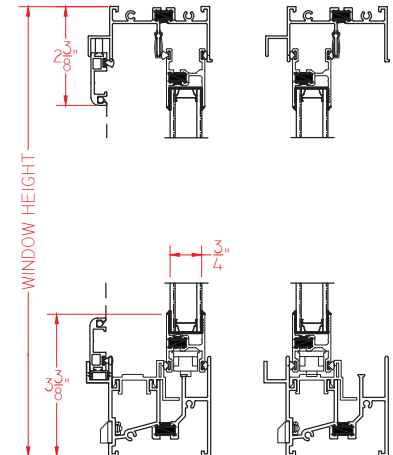

Aluminum Product Selection Guide

Single Hung/Double Hung

T500 Series

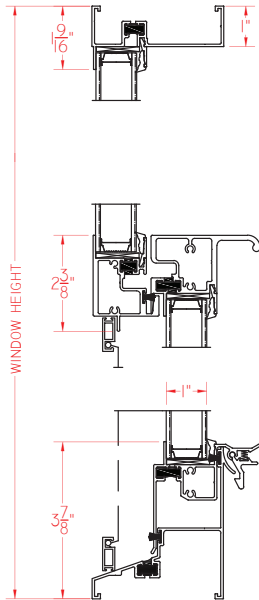

E300 Series

Double Hung model shown

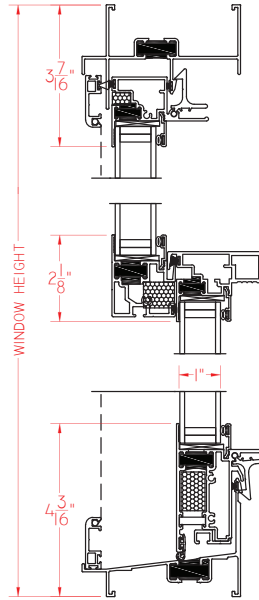

E500 Series

Double Hung model shown

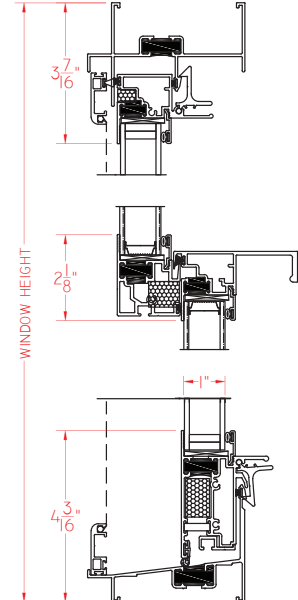

H650 Series

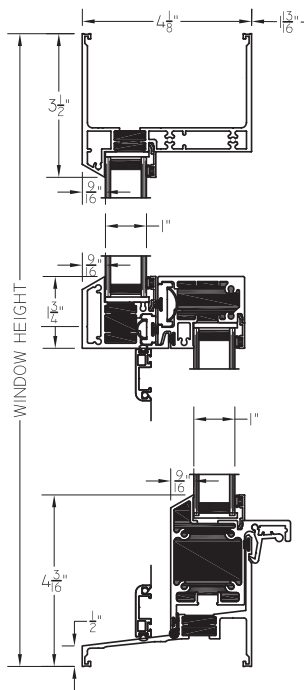

Hannibal High School
 Hannibal, MO
 General Contractor: Performance Services
 Glazing Contractor: American Glass

Aluminum Product Selection Guide

Fixed

C600 Series

Shown with nailing fin and modern, square exterior glazing

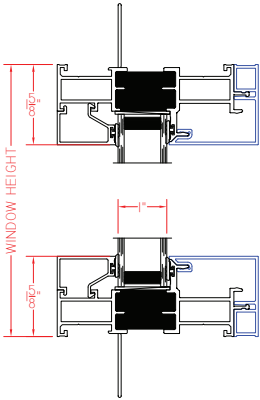

C605 Series

Shown with nailing fin and traditional, sloped exterior glazing

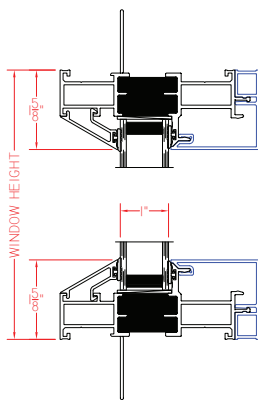

C605 Series with blinds/panel

Wide Rail Shown with traditional sloped exterior glazing, optional triple pane I.G. and optional blinds/panel
Narrow Rail

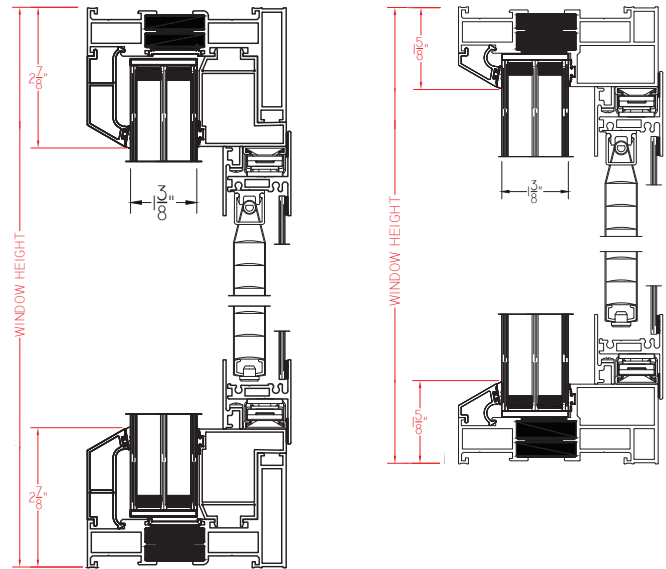

H450 Series

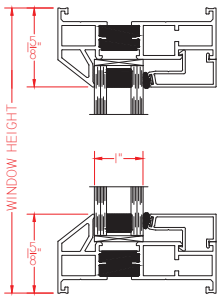

H650 Series

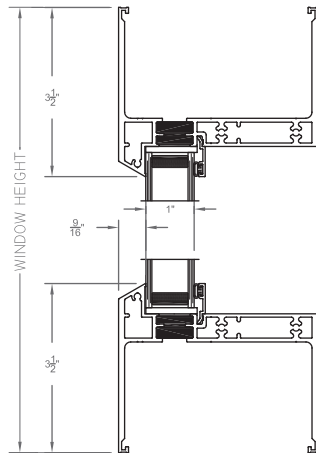

K200 Series

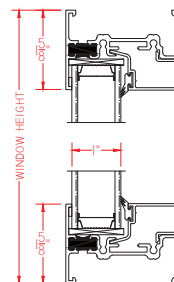

T600 Series

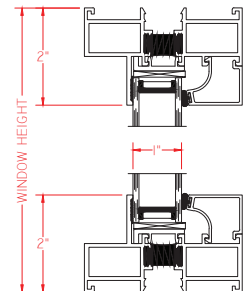

E600 Series

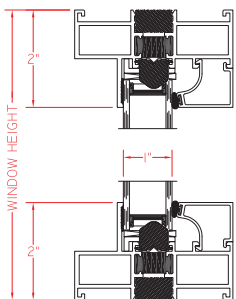

E600 Series with blinds/panel

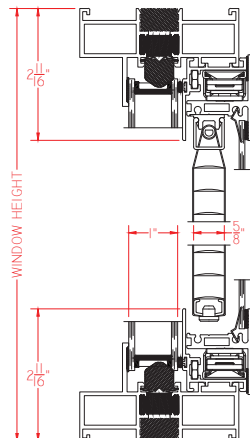

E300 Series

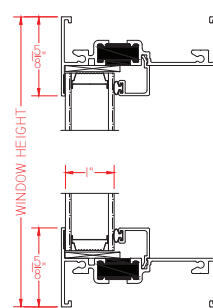

M600 Series

Shown with optional nailing fin

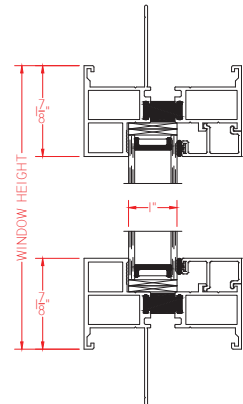

Vinyl Windows

Hung | Casement | Project-Out | Slider | Fixed



Bayless Junior High School
St. Louis, MO
Architect: RRJ Architects
Contractor: Wachter, Inc.
Comm. Window Distributor: Dalco Ind. Inc.

FEATURES:

- LC to CW Ratings
- 100% pure uPVC vinyl
- Fusion welded corners
- .060 Vinyl thickness
- Metal reinforcements in critical areas
- Amesbury/Truth® operating hardware
- Block & Tackle balancers on all hung units
- 3/4" to 1 3/8" I.G. with warm-edge spacer
- Full line of operating and fixed window models
- Product line encompasses New Construction and Replacement applications

BENEFITS:

- Value added alternative to traditional aluminum windows
- Industry-leading thermal efficiencies
- Green initiatives built into every product
- Impact and Florida Building approved products
- Standard I.G. achieves a minimum of 28 STC
- Custom painted exterior color capabilities*
- Standard and custom sizing for all models

*-some limitations may apply



www.QuakerCommercialWindows.com

Vinyl Windows and Doors

Model	Series	Frame Depth	Structural Test Rating	Test Size	Air Infiltration	Water Resistance	U-Value Range [#]	SHGC Range [#]	STC Range ^x	OITC Range ^x
Casement	V250	3 1/4"	LC35	32" x 60"	<.30	5.4	.21-.32	.11-.43		
	V300	3 1/4"	CW50	36" x 78"	<.30	7.5	.23-.28	.10-.42	34-41	29-34
Project-Out	V250	3 1/4"	LC35	48" x 32"	<.30	5.4	.22-.32	.11-.43		
	V300	3 1/4"	CW50	60" x 32"	<.30	7.5	.18-.28	.10-.42	35	29
Single Hung	V250	3 1/4"	LC35	44" x 75"	<.30	5.4	.23-.34	.13-.51		
	V300	3 1/4"	CW50	44" x 78"	<.30	7.5	as low as 0.25	as low as 0.21		
Double Hung	V250	3 1/4"	LC35	36" x 84"	<.30	5.4	.23-.33	.12-.50		
Horizontal Slider	V250	3 1/4"	LC35	63" x 44"	<.30	5.4	.23-.35	.13-.50		
	V300	3 1/4"	CW50	71" x 60"	<.30	7.5	as low as 0.25	as low as 0.21		
Fixed	V250	3 1/4"	LC35	56" x 56"	<.30	5.4	.20-.32	.13-.53		
	V300	3 1/4"	CW50	78" x 78"	<.30	7.5	.14-.28	.15-.49	35	29

*-Ranges based on multiple Low-E/Argon I.G. combinations

^x-Ranges based on multiple I.G. combinations

All ratings listed are NAFS certified. Periodic re-certification testing is required thus data shown may vary slightly.

Casement

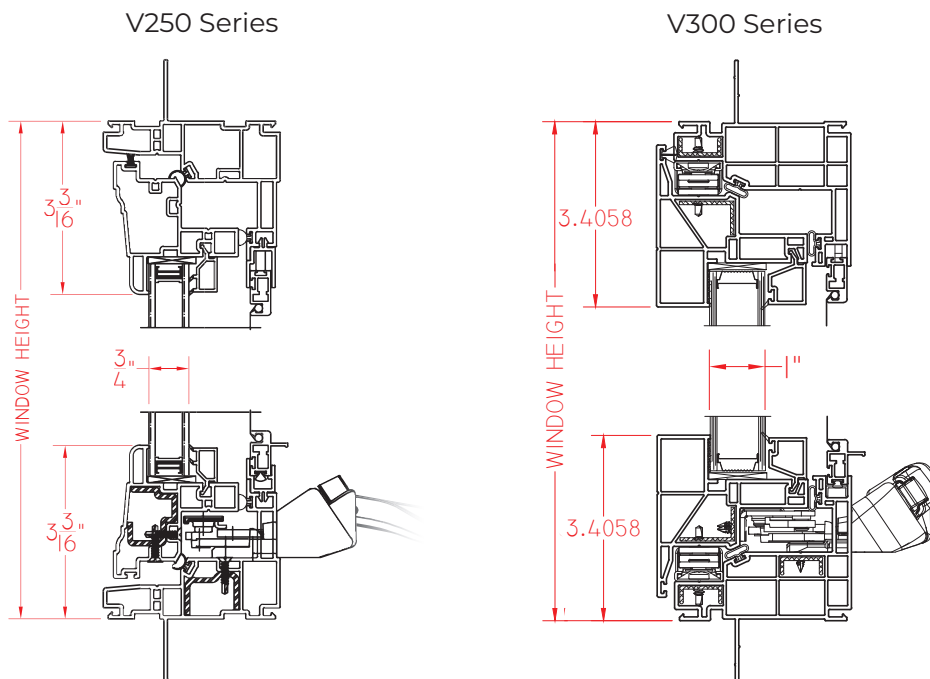

Vinyl Product Selection Guide

Project-Out



V250 Series

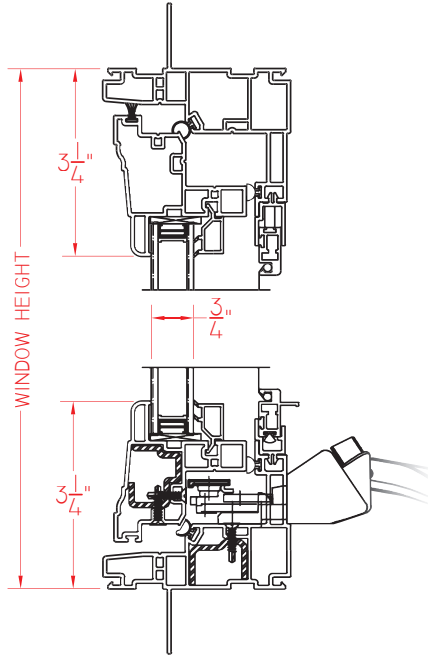

V300 Series

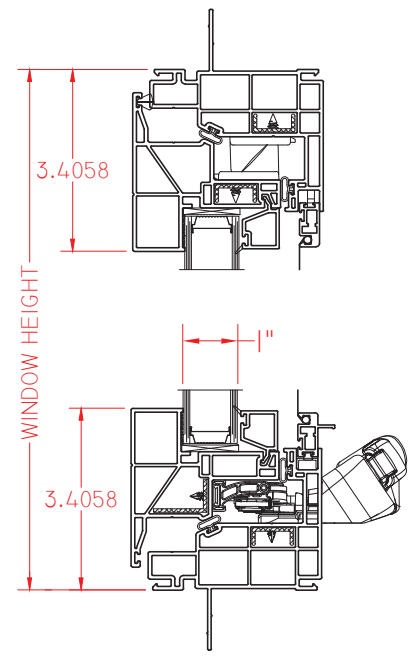

Single Hung / Double Hung

V250 Series Double Hung

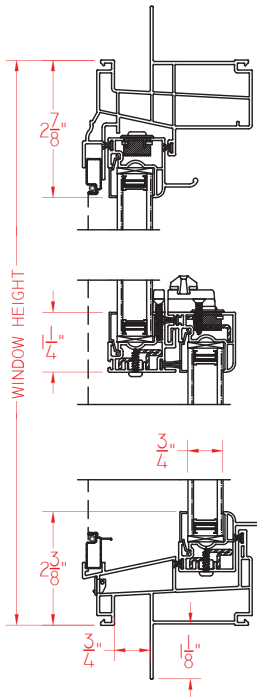

V250 Series Single Hung

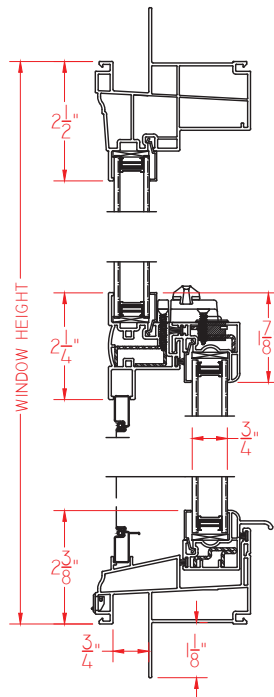

V300 Series Single Hung

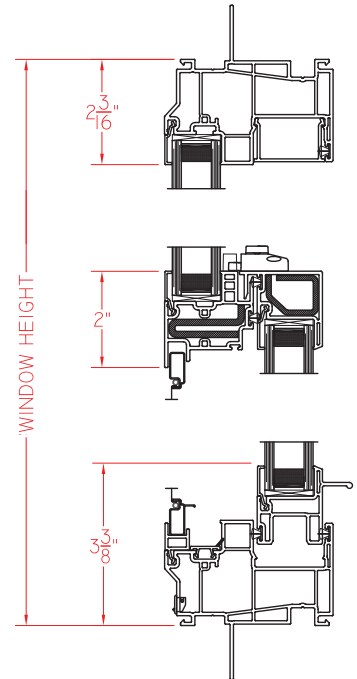

Vinyl Product Selection Guide

Horizontal Slider

V250 Series

Single Slider model shown

V300 Series

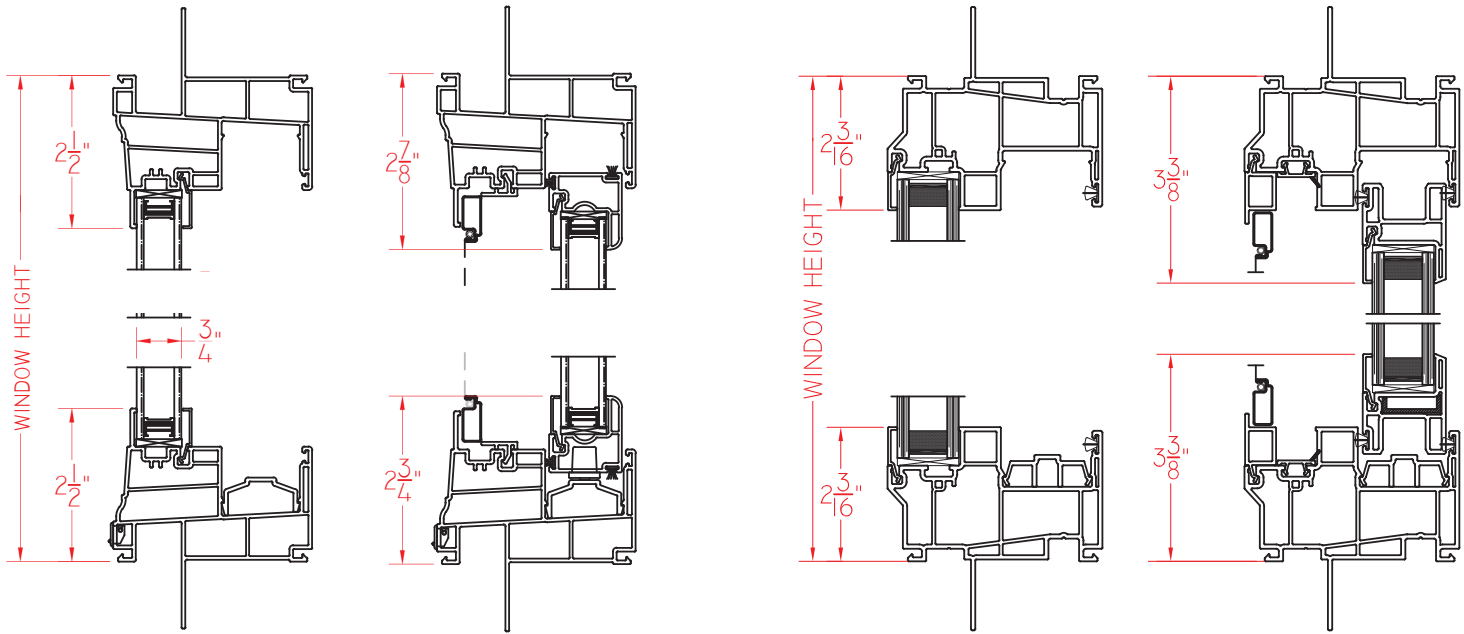

Fixed

V250 Series

Sash set model to match all hung and horizontal sliding units

V250 Series

Sash set model to match all casement and project-out units

V300 Series

Sash set model to match all casement and project-out units

V300 Series

Sash set model to match all hung and horizontal sliding units

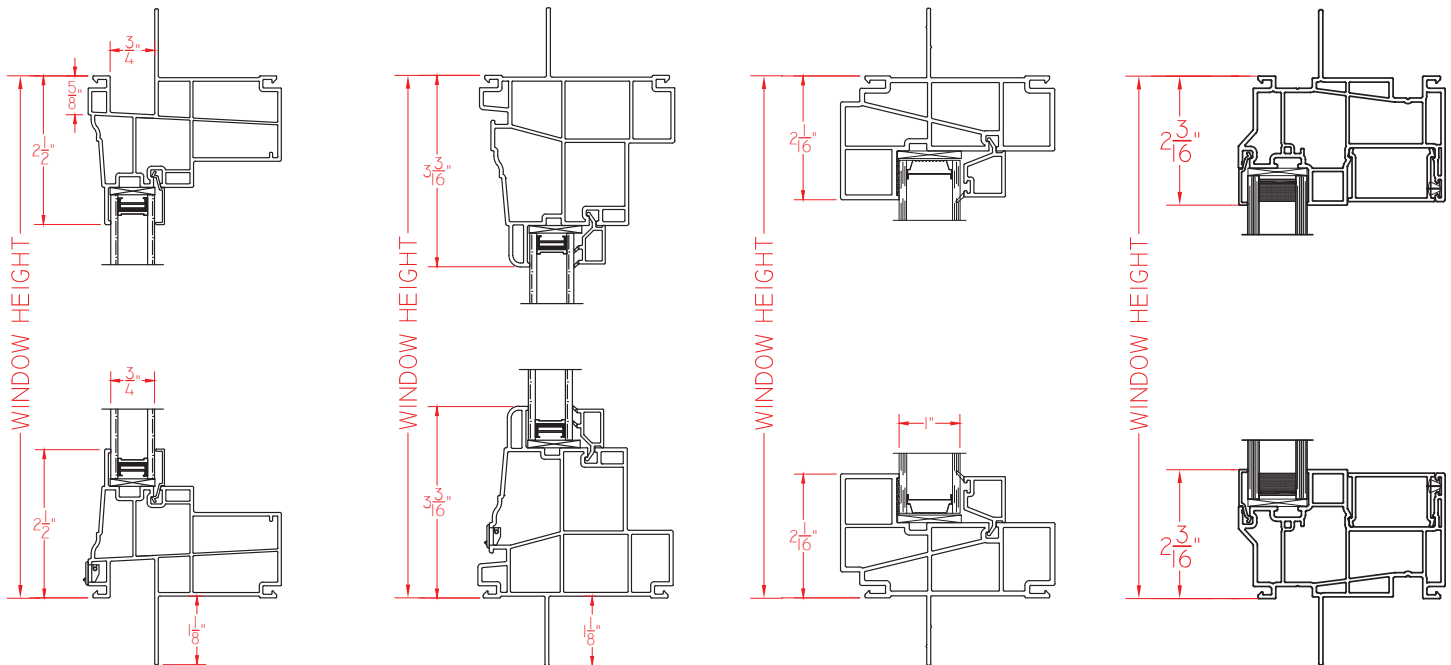

Options

Accessories, Colors, Finishes

Installation Accessories



Trinity Falls Prep School
Tinton Falls, NJ
General Contractor: Sweetwater Const.
Architect: Studio Hillier Architecture
Glazing Contractor: Glass Castle of NJ

Quaker can provide a multitude of installation accessories for both aluminum and vinyl products.

- Receptors and Subsills
- Panning and Break Metal
- Vertical and Horizontal Mull Systems. Factory muller or sent loose for jobsite installation*
- Trim
- Decades of experience producing custom, job-specific accessory dies

**Some limitations may apply*

Colors & Finishes

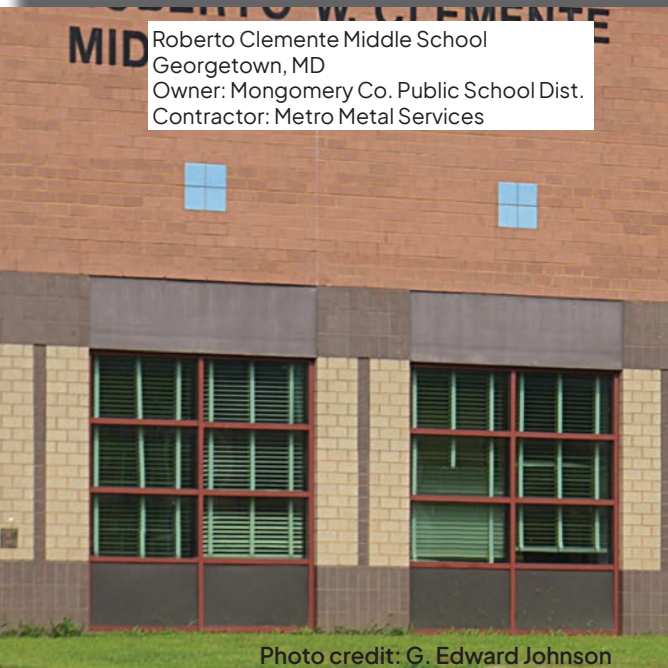

Roberto Clemente Middle School
Georgetown, MD
Owner: Montgomery Co. Public School Dist.
Contractor: Metro Metal Services

Photo credit: G. Edward Johnson

For Quaker Aluminum Windows:

- Finishes: FGIA 2604 Finish is our standard. Upgrades to a 2605 finish are available for most colors.
- Choose from 30 "Quick-Pick" colors. If that's not enough, our custom color capabilities put any color at your fingertips.
- Class I Anodized is available upon request

For Quaker Vinyl Windows:

- Pure uPVC in White or Sandstone vinyl colors
- Painted Vinyl: Available for exterior only, Quaker's painted vinyl affords a color palette which far exceeds traditional expectations because of an ability to produce any custom color you have in mind.
- FGIA 615-05 is the standard finish for all painted vinyl colors
- High-Performance Laminate Coatings: Laminate coatings, which are in accordance to RAL GZ 716/1, can be used on the exterior of all vinyl products. For a limited amount of Quaker's vinyl windows, laminate can be added to the interior too.



Options

Glass & Grids

Glass

Pane thickness:

- $\frac{3}{32}$ "
- $\frac{1}{8}$ "
- $\frac{5}{32}$ "
- $\frac{3}{16}$ "
- $\frac{1}{4}$ "
- $\frac{5}{16}$ "

I.G. thickness:

- $\frac{3}{4}$ " (Double pane)
- 1" (Double pane)
- $1\frac{3}{8}$ " (Triple pane)

Glass Types:

- Dual Silver Low-E
 - Triple Silver Low-E
 - Interior Pane Low-E
 - Tempered Safety Glass
 - Laminated
 - Spandrel
 - Solar-Cooled
 - Obscure (for privacy)
 - Tinted
 - Bird Glass
- and many others

Some limitations may apply based upon several variables including but not limited to the window/door series chosen and requested/required specifications.



Eldon Middle School
Eldon, MO
General Contractor: Verslues Construction
Comm. Window Distributor: Becker Millwork

Grids

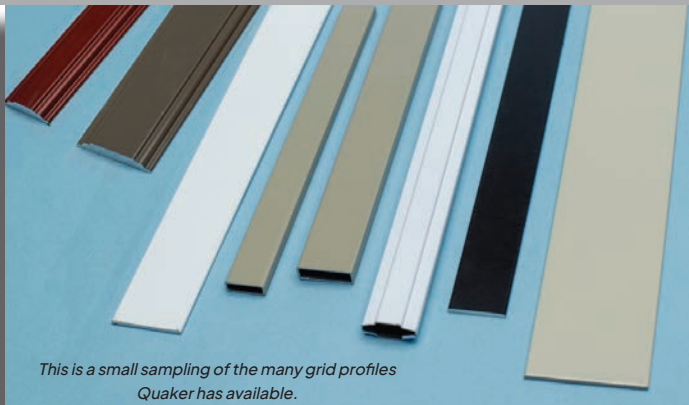

This is a small sampling of the many grid profiles Quaker has available.

Grids Between the Glass:

- Flat ($\frac{5}{8}$ ", $\frac{3}{4}$ " or 1")
- Contoured ($\frac{3}{4}$ "

Simulated Divided Lites:

- Numerous profiles and combinations available ($\frac{1}{2}$ " to $3\frac{3}{4}$ " wide)

Some limitations may apply



Columbus Collegiate Academy West
Columbus, OH
Owner: United Schools Network
Architects: Triad Architects
Contractor: Corna-Kokosing Const.
Dealer: Northern Window & Door

Quaker

Support Services

Quaker's expertise and support services are unmatched in the industry. While every K-12 project is distinct, Quaker offers in-house processes which consistently cover every detail. These fool-proof procedures ensure your project and our products are a perfect match.

- Quaker has a dedicated commercial team with more than 125 years of industry experience
- Quaker's team will assist with every facet; design development, budgetary aspects, and project management



PROJECT AND SPECIFICATION REVIEW

How many stories are in the building?
Where is it located?
How large are the windows?
These and other important questions must be answered before moving forward.



ENGINEERING & DESIGN ASSESSMENT

After evaluating every component making up your project, our professional engineering expertise is put to work, as we carefully calculate customized solutions to best meet your spec's requirements.



LOCAL AND ARCHITECTURAL SALES SUPPORT

Quaker's Sales Representatives, many with 25+ years of knowledge and industry pedigree, have a vested interest in working beside you...not from afar. If you have questions, they want to answer them. If you have a concern, it's their concern too.



The Quaker Difference: More than meets the eye.

What distinguishes Quaker from all other window companies isn't always in plain sight. It's The Quaker Difference -- tangible and intangible assets working together to form the most sought-after windows in the market.

- It's a standard of craftsmanship and engineering excellence that we build into every product, distinguishing us from all other window companies in America.
- It's shying away from testing at entry-level, gateway sizes. Instead, we test using exaggerated and even maximum sizing. This ensures the entire scope of a product's sizing will meet the advertised rating.
- It's our "can-do" attitude toward custom projects. Never is a job too custom for Quaker. Our options and accessory choices allow us to do what others can't.
- It's multiple quality checks implemented throughout the manufacturing process to guarantee a paramount product.
- It's our state-of-the-art powder paint facility, one of the largest in the U.S., which allows us to control the quality and consistency of our finish, unlike manufacturers that outsource their painting. As well, it supports our "green" initiatives by employing environmentally-friendly coatings that emit nearly zero VOCs into the air.
- It's employing thicker glass panes which will both lower the amount of stress cracks and raise your ability to control sound intrusion.
- It's professional manufacturing specialists, some with more than 40 years of window experience, providing unparalleled attention to detail from start to finish.
- It's a sales team fully-dedicated to the commercial building sector, working hard to ensure that the product you need is the product you order.
- It's doing more than just selling windows and doors. It's finding the right window and door solution for your project.



That's *The Quaker Difference*.

Arlington High School
Arlington, MA
General Contractor: Consigil Construction Co.
Architect: HMFH Architects
Glazing Contractor: R & R Window Contractors

800-347-0438



References

See more of Quaker in recently completed projects for these schools

ALABAMA

North Sand Mountain High School - Bryant

ARIZONA

Red Rock Day School - Red Valley
Cartwright School District #83 - Phoenix

ARKANSAS

Sloan-Hendrix School District - Imboden

COLORADO

Bryant Webster Elementary - Denver
Colfax Elementary - Denver

CONNECTICUT

Tolland Middle School - Tolland

DELAWARE

Newark Charter School - Newark

FLORIDA

Chumuckla Elementary - Jay

GEORGIA

Pebblebrook High School - Mableton
Tift County School District - Tifton

IDAHO

Hawthorne Elementary - Boise

ILLINOIS

Baldwin Elementary - Quincy
Denman Elementary - Quincy
Iles Elementary - Quincy
Macomb Middle School - Macomb
Riley Comm. Consolidated School Dist. - Marengo
Robert Fulton Elementary - Chicago
Rooney Elementary - Quincy

INDIANA

Herron Preparatory Academy - Indianapolis
Lake Ridge New Tech School - Gary

IOWA

Sidney Elementary - Sidney
Solon High School - Solon

KANSAS

USD 316 Golden Plains Elementary - Selden

KENTUCKY

St. Martha Catholic School - Louisville

LOUISIANA

Lincoln Preparatory School - Grambling
St. Augustine High School - New Orleans
St. James Episcopal Day School - Baton Rouge

MARYLAND

Greencastle Elementary - Silver Spring
Landon School - Bethesda
Laytonsville Elementary - Gaithersburg
Monocacy Elementary - Dickerson
Poolesville Elementary - Poolesville
Sherwood Elementary - Sandy Spring
Town Creek Elementary - Lexington Park

MASSACHUSETTS

Raymond E. Shaw Elementary - Millbury
Rollins School - Lawrence
St. Mark's School - Southborough
Yeshiva Ohr Yisrael School - Chestnut Hill

MICHIGAN

Robert Nickels Intermediate School - Byron Center
St. John's Lutheran School - Grand Haven

MINNESOTA

Browerville Public School - Browerville
Plainview-Elgin-Millville High School - Plainview
St. Frances de Sales School - St. Paul

MISSISSIPPI

Alcorn Central Elementary - Glen
Attala County School District - Kosciusko
Brandon Middle School - Brandon
Chastain Middle School - Jackson
Choctaw County High School - Ackerman
Ethel High School - Ethel
Greenlee Elementary - McCool
Grenada Elementary - Grenada
Indianola Academy - Indianola
McAdams High School - Sallis
Pearl River County Elementary - McNeill

MISSOURI

Central VPA High School - St. Louis
City Garden Montessori School - St. Louis
Clearwater High School - Piedmont
East Elementary - Jefferson City
Hallsville Primary School - Hallsville
Hannibal High School - Hannibal
Hannibal Middle School - Hannibal
Marian Middle School - St. Louis
Mark Twain High School - Center
Missouri School for the Deaf - Fulton
Nottingham CAJT High School - St. Louis
Novinger High School - Novinger
Smithton R-6 - Smithton
Southland C-9 School District - Cardwell
Vienna High School - Vienna

Godwin Hall
North Carolina School of Science & Mathematics
Morganton, NC
Owner: NCSSM
Architect: Duda Paine Architects
Contractor: Barnhill Contracting
Glazing Contractor: Carolina Classic Windows & Glass



NEBRASKA

Emerson Elementary - Alliance
Grandview Elementary - Alliance
Valentine High School - Valentine

NEW YORK

St. Catherine's R&E May School - Albany

NORTH CAROLINA

North Newton Elementary - Lexington
Pine Springs Preparatory Academy - Holly Springs
Yadkin Valley Regional Career Academy - Lexington

OHIO

Bishop Hartley High School - Columbus
St. Ignatius High School - Cleveland

OKLAHOMA

Primrose School of South Tulsa - Tulsa

OREGON

Hanby Middle School - Gold Hill
Medford School District - Medford
Sisters Elementary - Sisters

PENNSYLVANIA

Carmalt PreK-8 Academy - Pittsburgh
Gateway Middle School - Monroeville
The Goddard School - Philadelphia

RHODE ISLAND

North Smithfield School District - North Smithfield

SOUTH CAROLINA

Newberry Elementary - Newberry

TENNESSEE

Center Hill Middle School - Memphis
Collierville School System Admin. Bldg. - Collierville

TEXAS

Doss School - Doss
Fort Worth County Day School - Fort Worth
Frona ISD High School - Frona
Meadows Independent School District - Lubbock

VERMONT

St. Francis Xavier School - Winooski

WASHINGTON

Aberdeen School Dist. Administration Bldg. - Aberdeen

WEST VIRGINIA

Burnesville Elementary - Burnesville

WISCONSIN

Tenor High School - Milwaukee
Veritas High School - Milwaukee
Winskill Elementary - Lancaster



K-12 SCHOOLS

Find more information on Quaker windows and doors



 www.QuakerCommercialWindows.com

 1-800-347-0438

 commercial@quakerwindows.com



Made in America: All Quaker products are designed and manufactured in the United States at our state-of-the-art facilities in Eldon, MO (above) and Freeburg, MO.



January, 2024 V2



ON THE COVER:

Martin Luther King Middle School
Hartford, CT
General Contractor: Downes Construction
Architect: JCJ Architecture
Glazing Contractor: Cherry Hill Glass Co.